

DIRECCIÓN DE PLANIFICACIÓN

universidad nacional de Itapúa



Anteproyecto de la Facultad de Medicina

ANTEPROYECTO FACULTAD DE MEDICINA



Ubicación

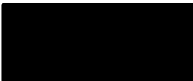

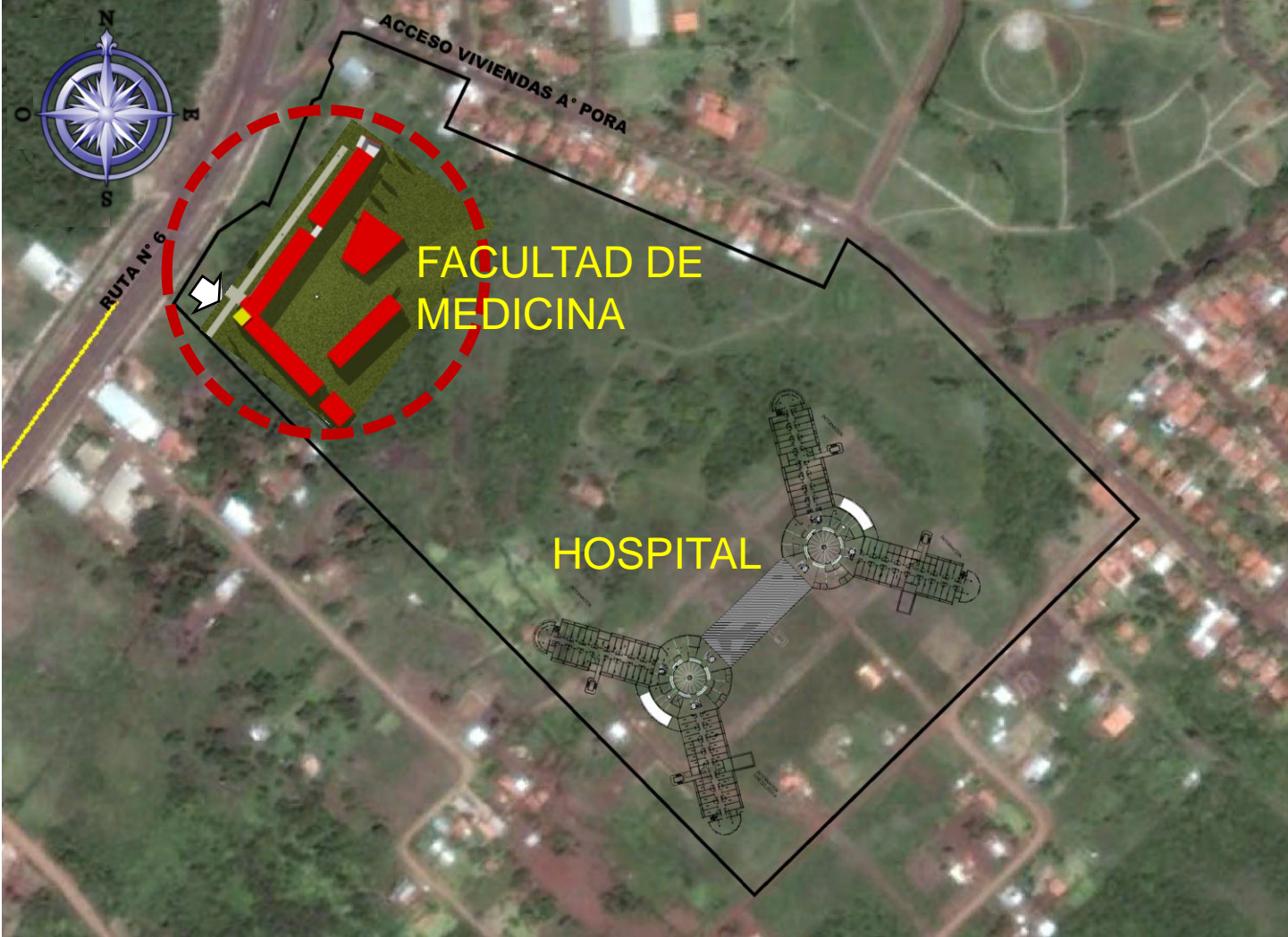

Implantación

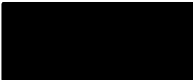

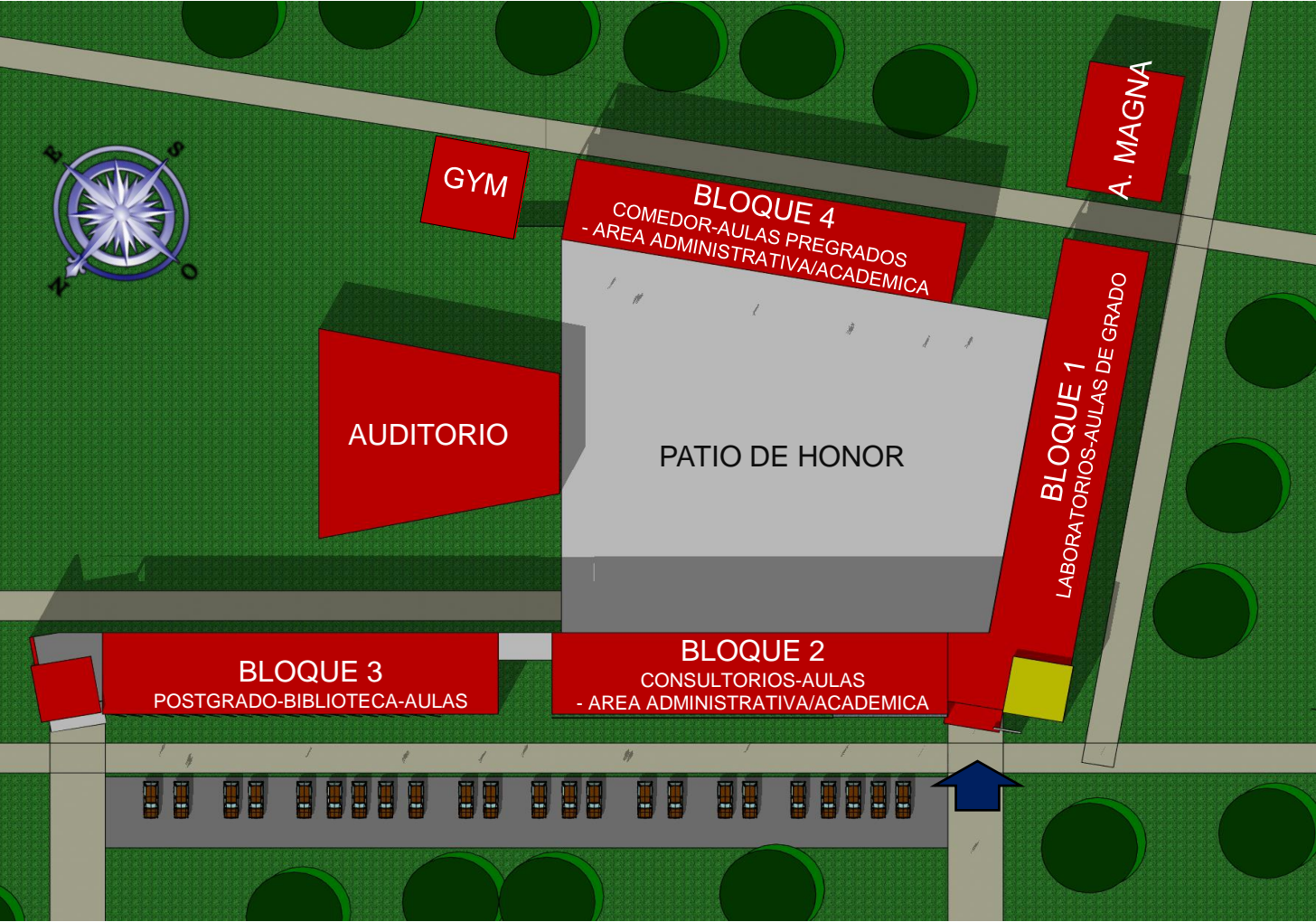

Planta general

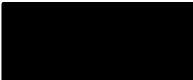



INVERSIÓN ESTIMADA

**Monto estimativo:
3.500.000Us**

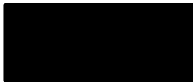

ANTEPROYECTO FACULTAD DE MEDICINA

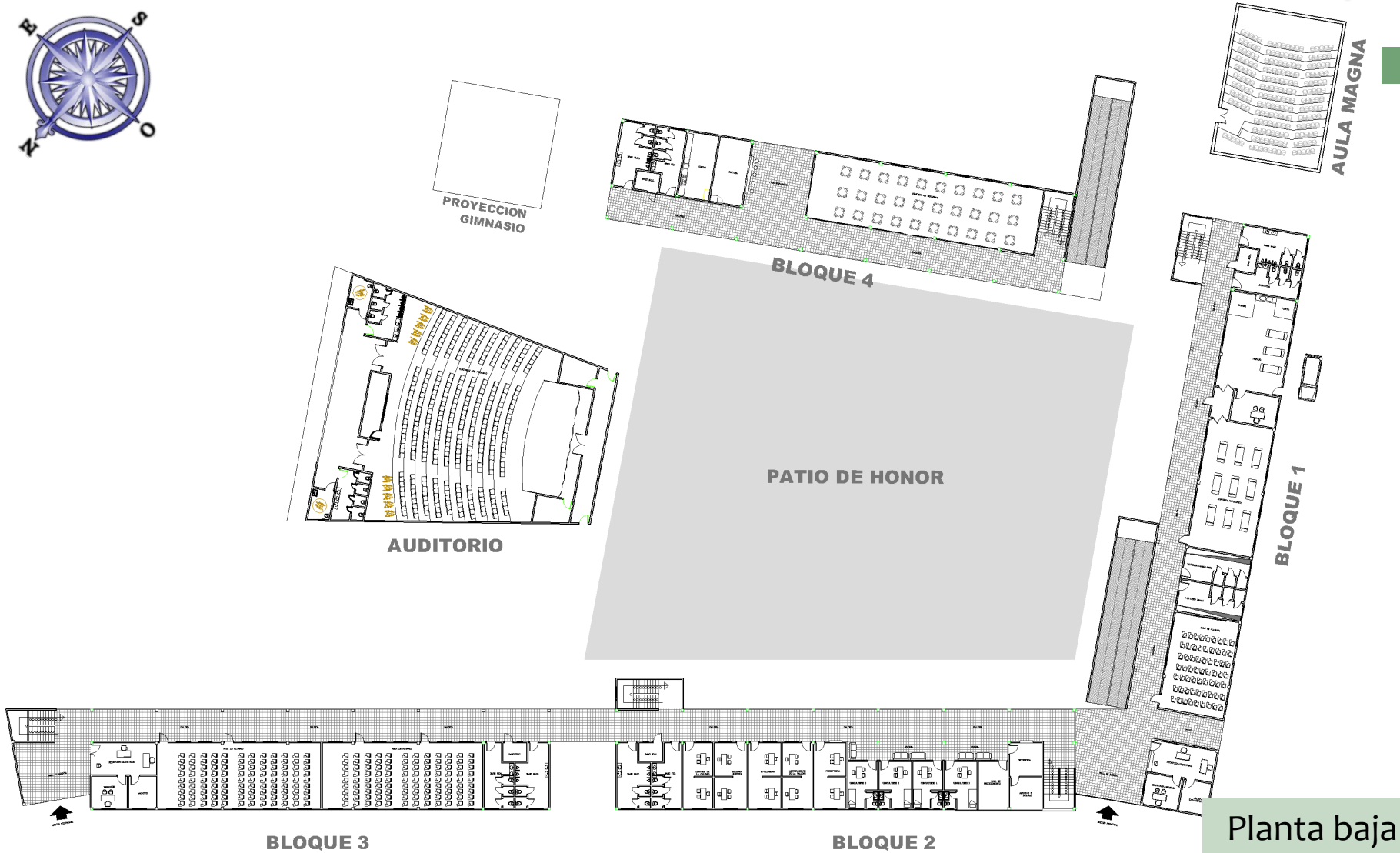

Planta baja

ANTEPROYECTO FACULTAD DE MEDICINA

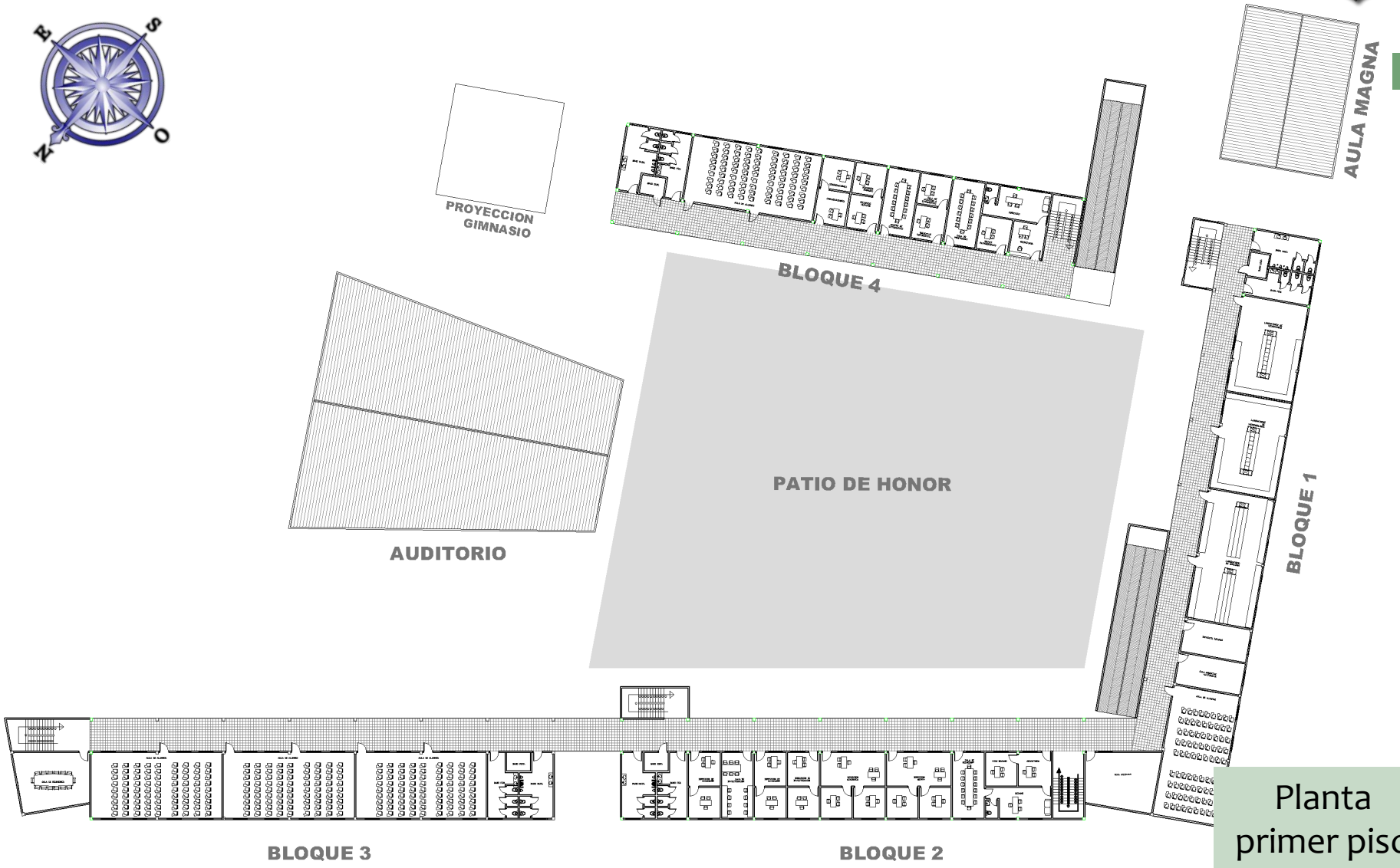

Planta primer piso

ANTEPROYECTO FACULTAD DE MEDICINA

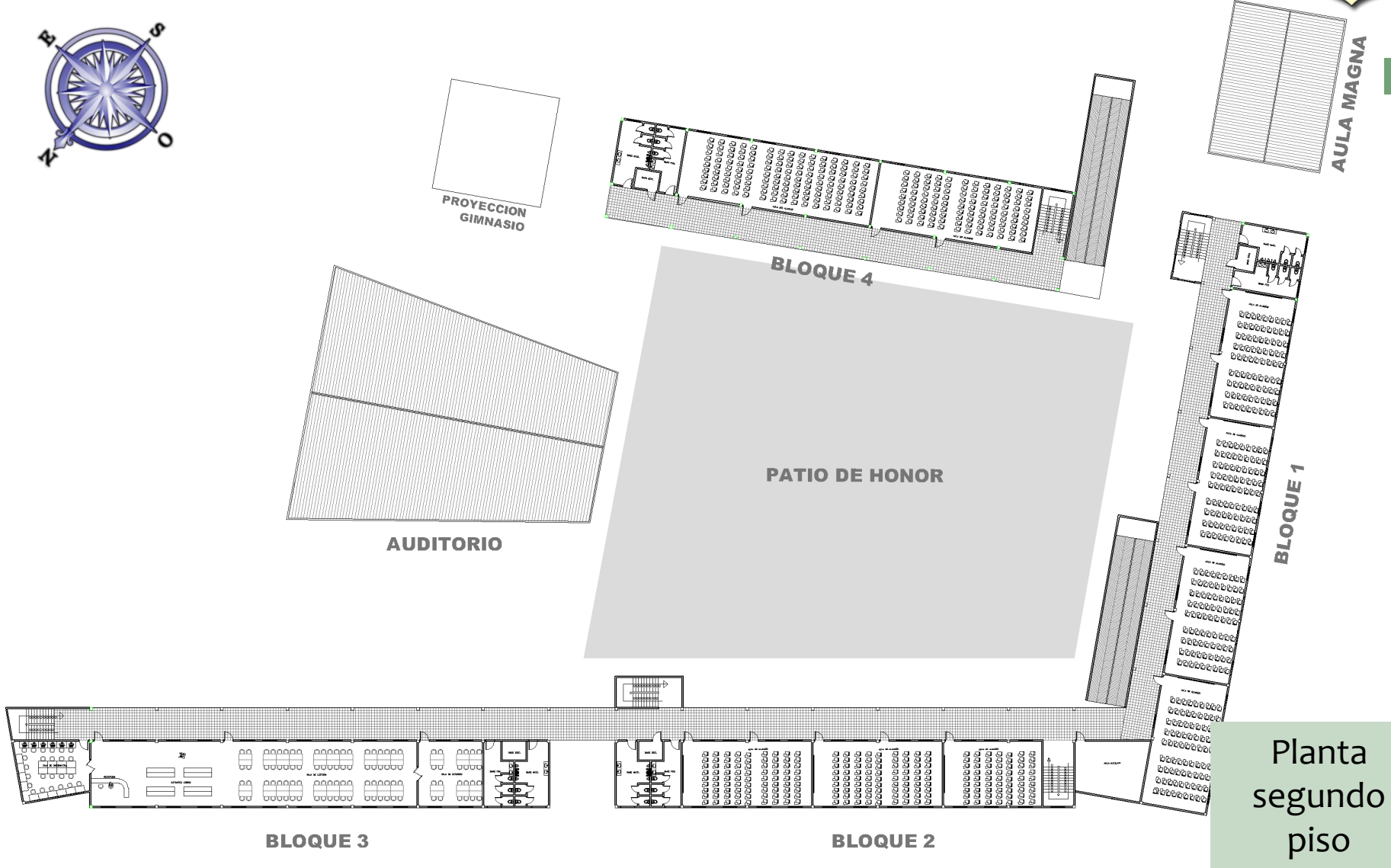

Planta
segundo
piso

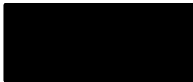

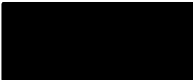
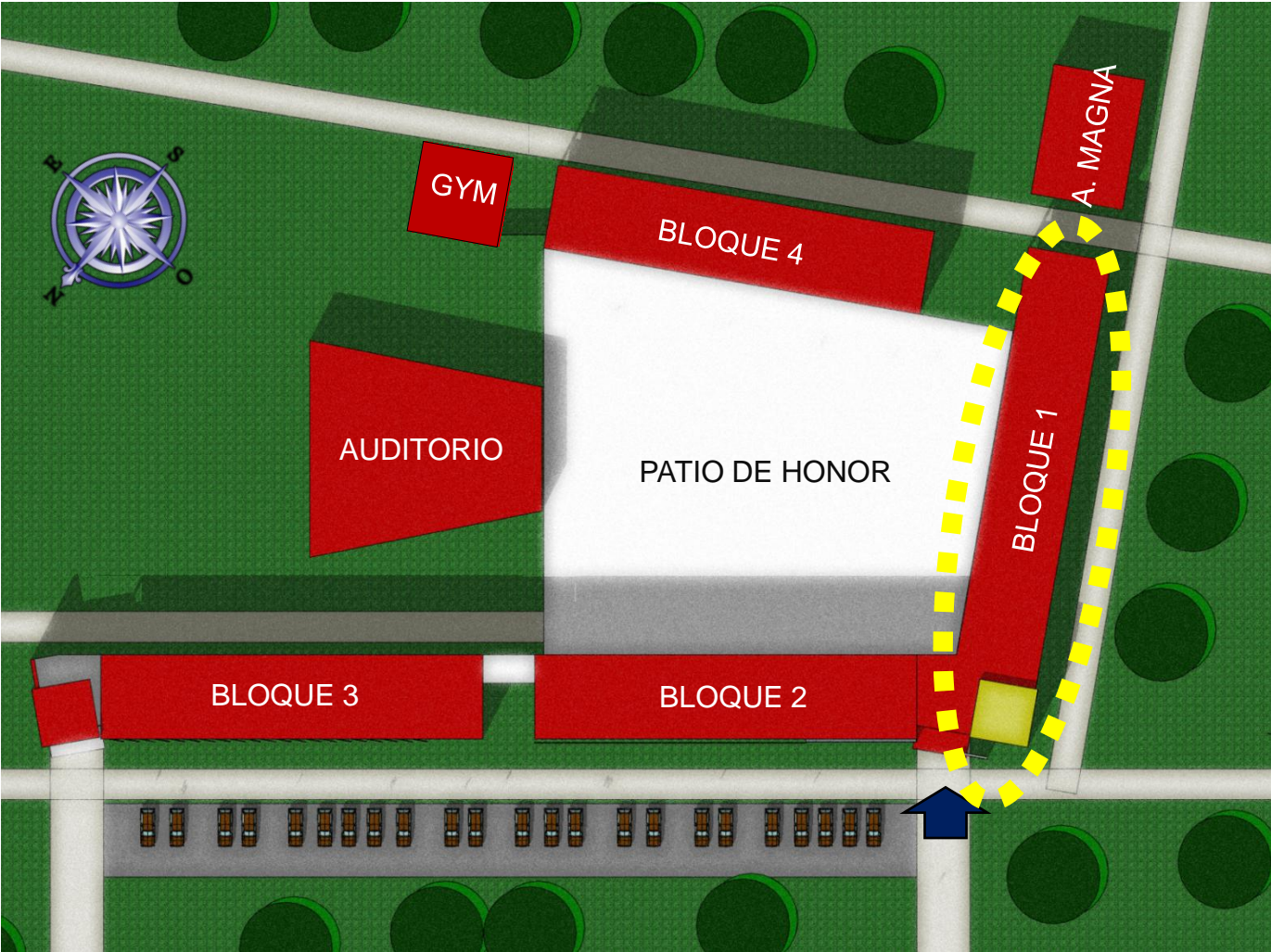

ANTEPROYECTO FACULTAD DE MEDICINA



PLANTA BAJA



LABORATORIOS

PLANTA 1ER PISO

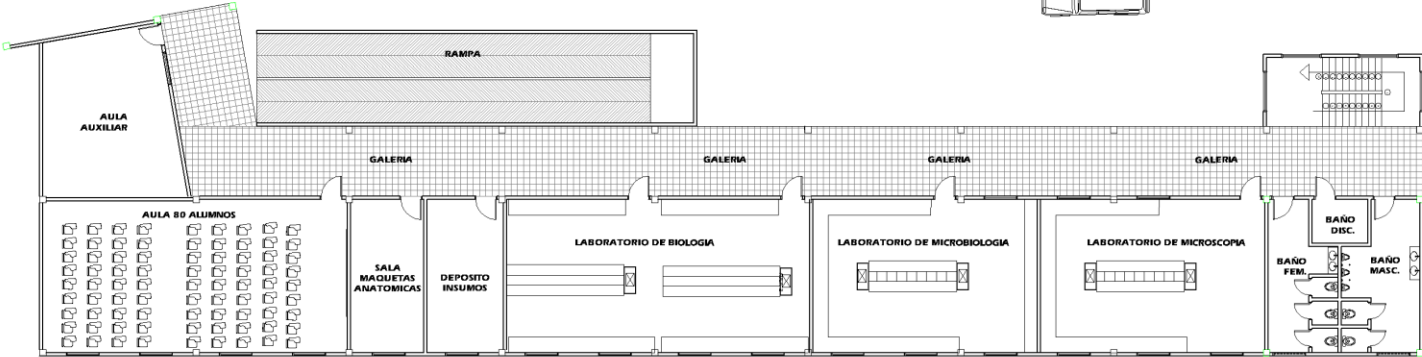

LABORATORIOS

PLANTA 2DO PISO

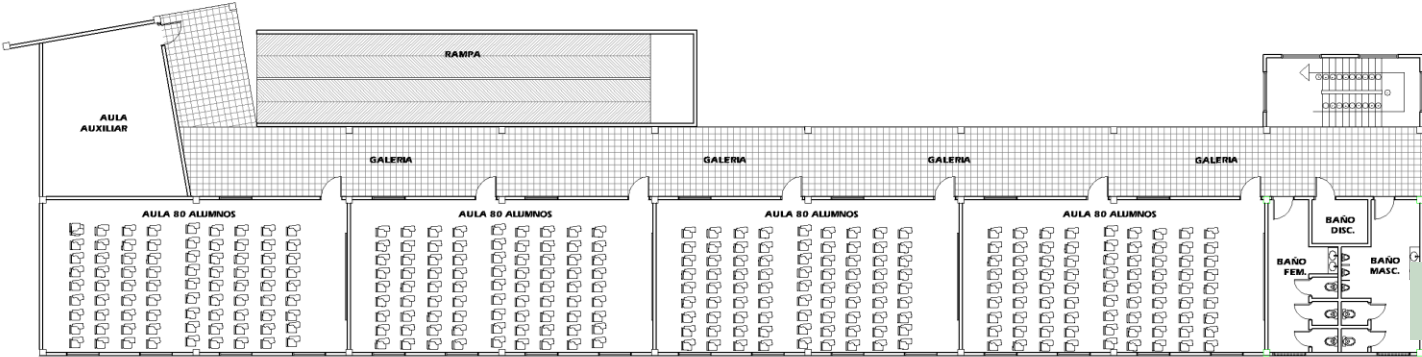

AULAS DE GRADO

Bloque 1

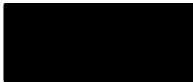



ANTEPROYECTO FACULTAD DE MEDICINA

PLANTA BAJA

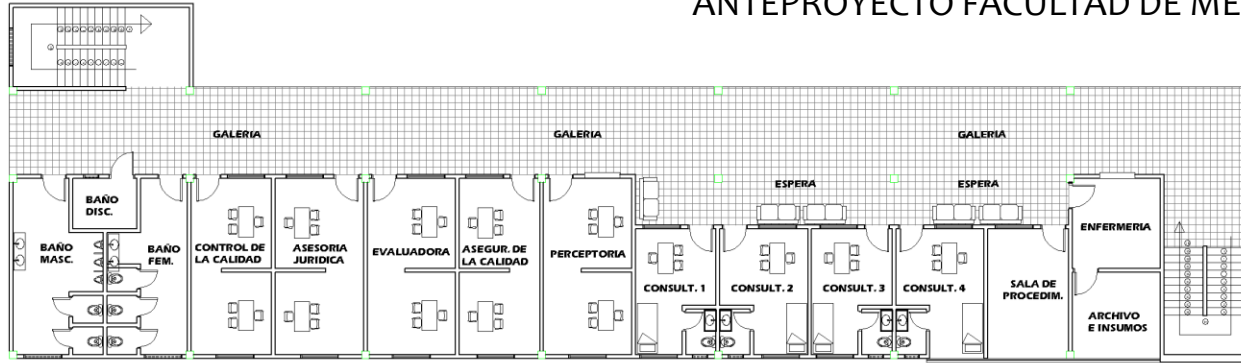

CONSULTORIOS

PLANTA 1ER PISO

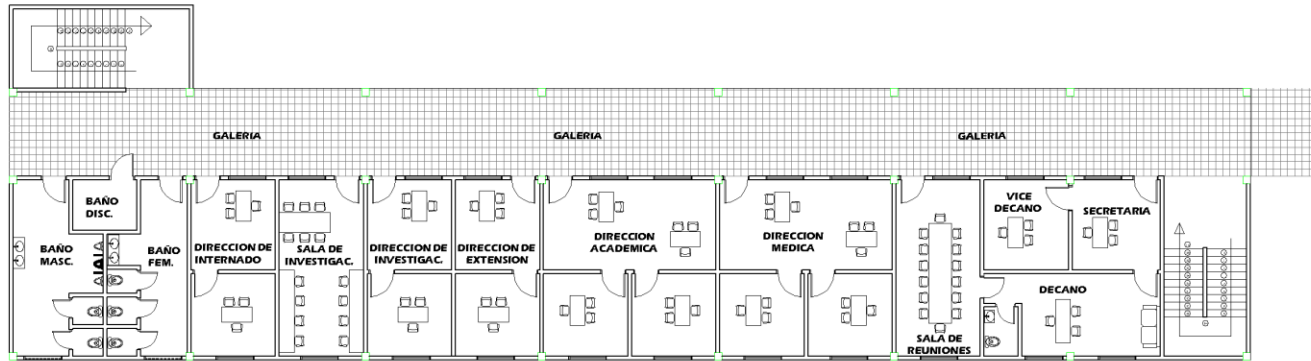

AREA ADMINISTRATIVA/ACADEMICA

PLANTA 2DO PISO

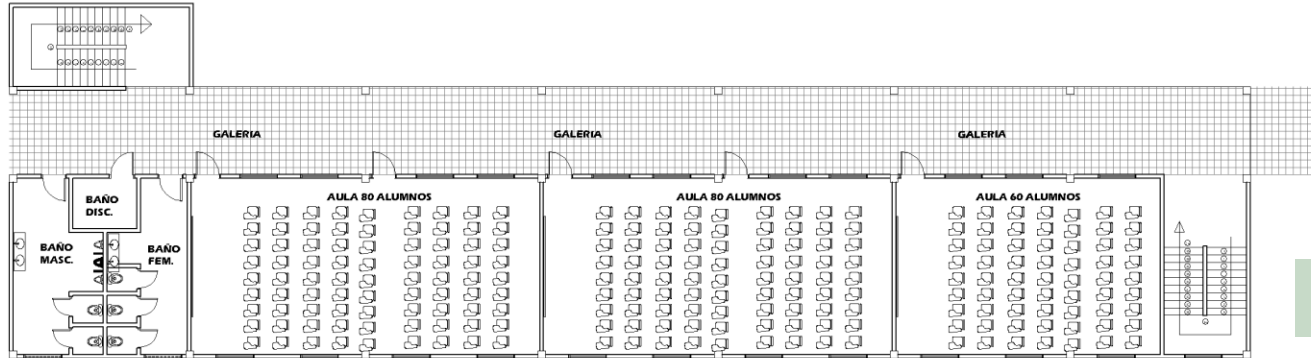

AULAS

Bloque 2

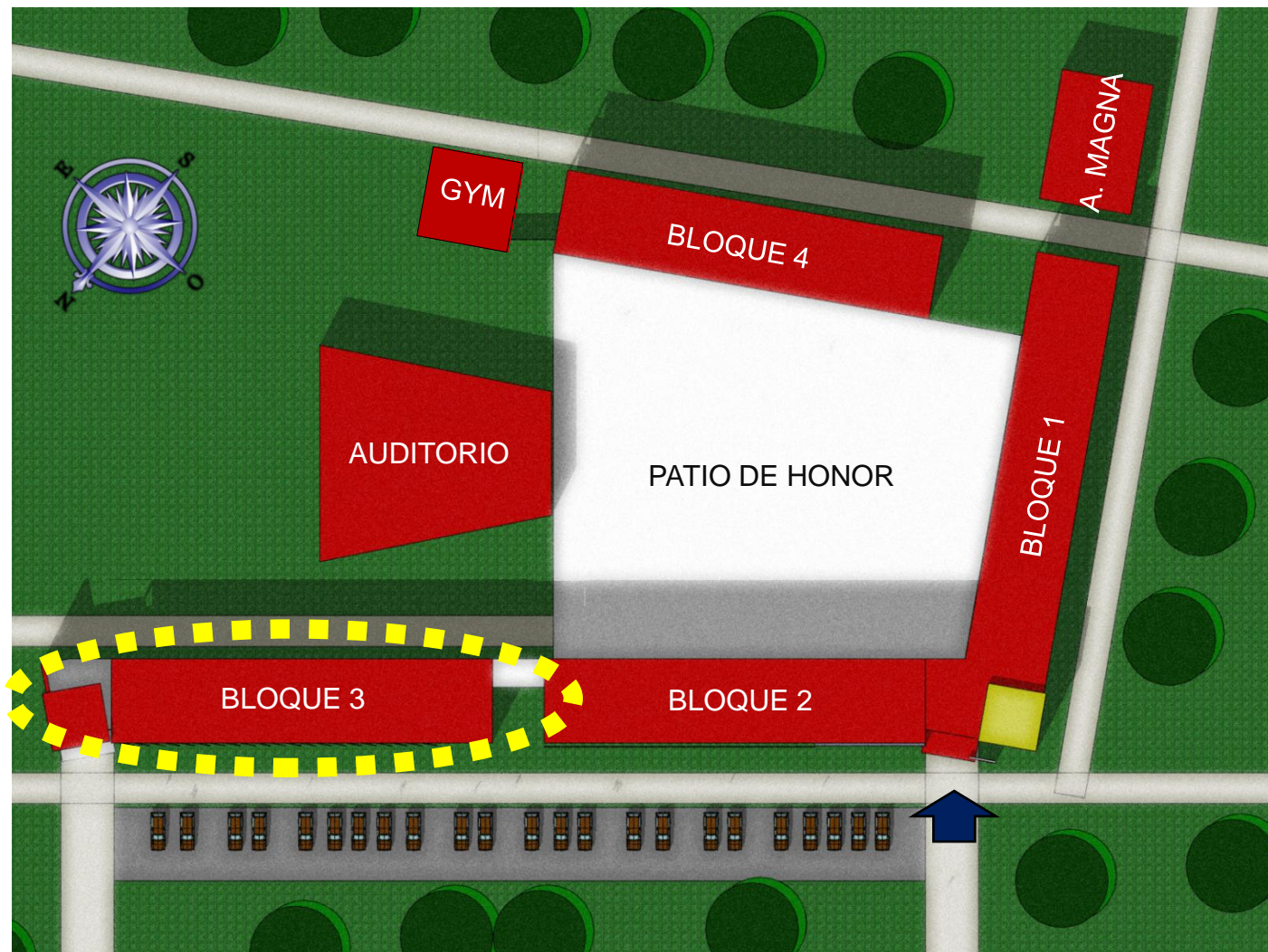

ANTEPROYECTO FACULTAD DE MEDICINA



PLANTA BAJA

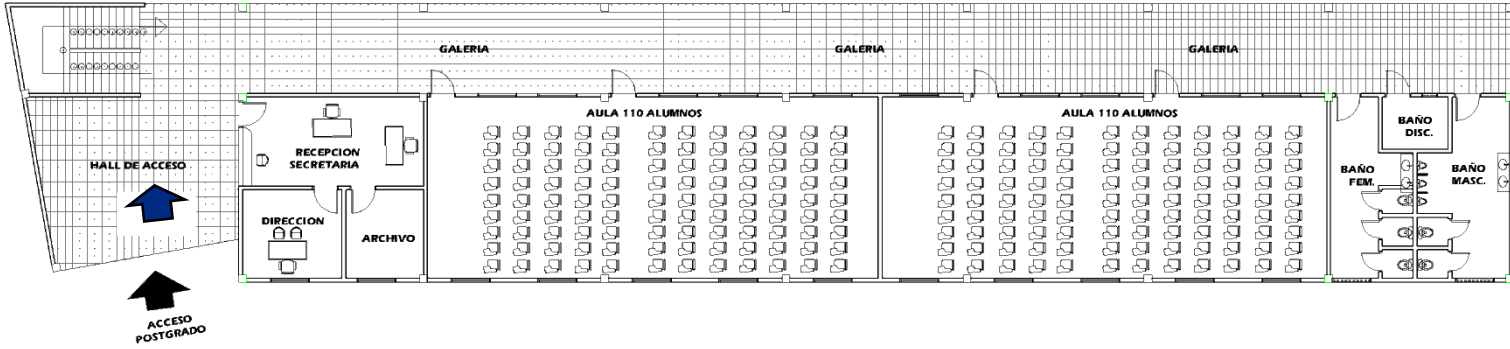

PLANTA 1ER PISO

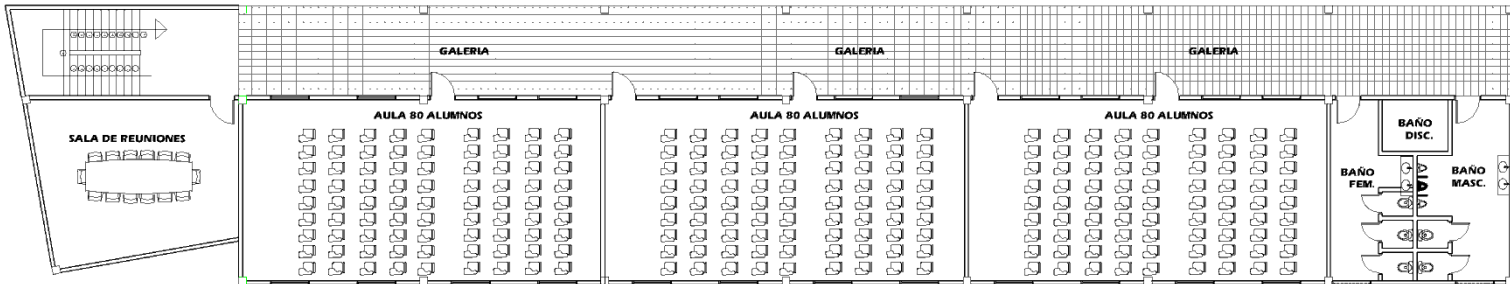

PLANTA 2DO PISO

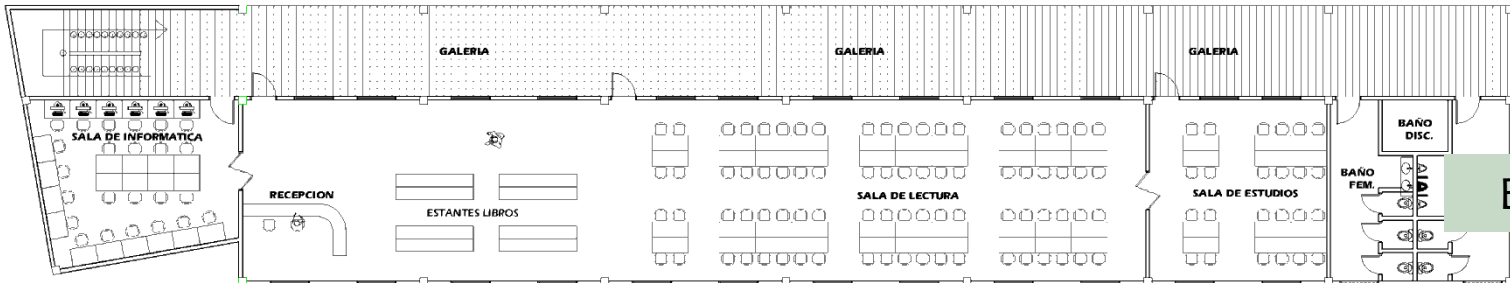

POSTGRADO-AULAS

BIBLIOTECA

Bloque 3

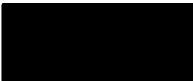
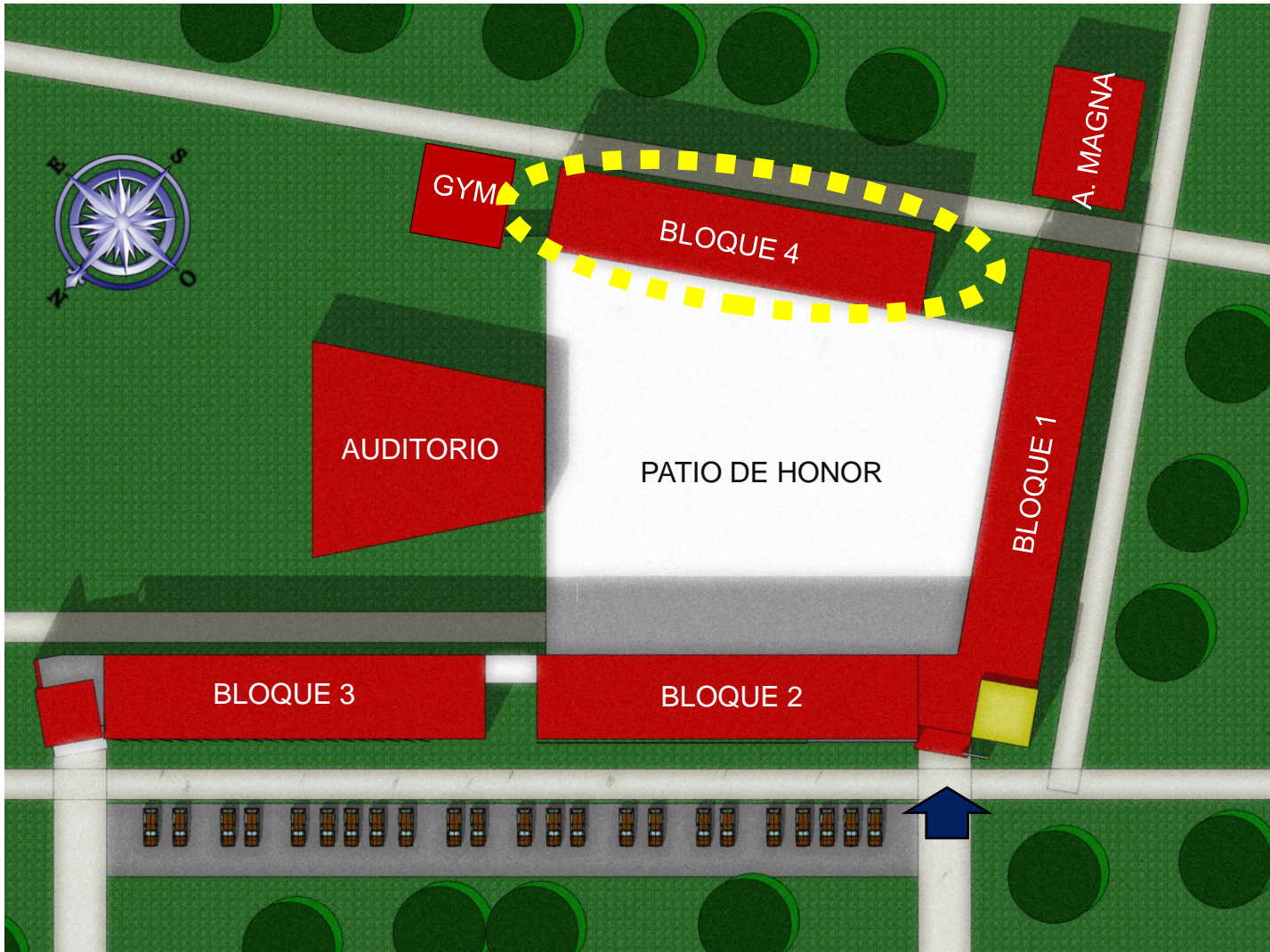

ANTEPROYECTO FACULTAD DE MEDICINA



PLANTA BAJA

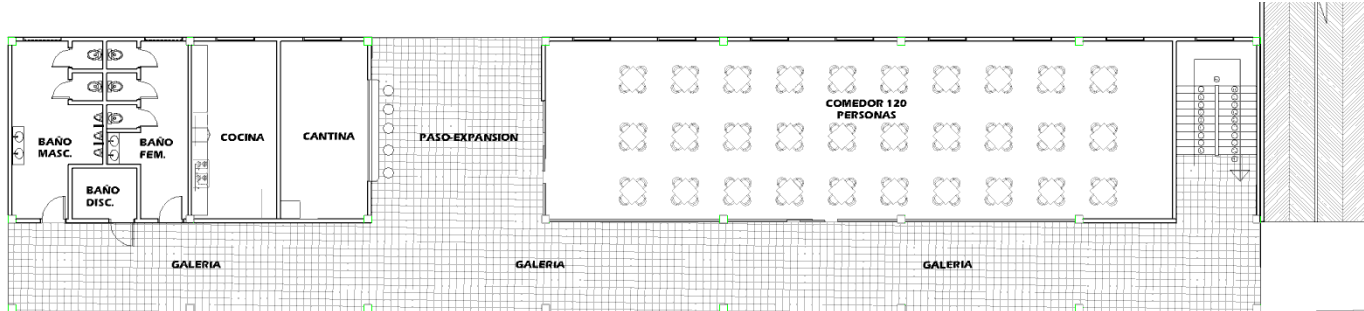

COMEDOR

PLANTA 1ER PISO

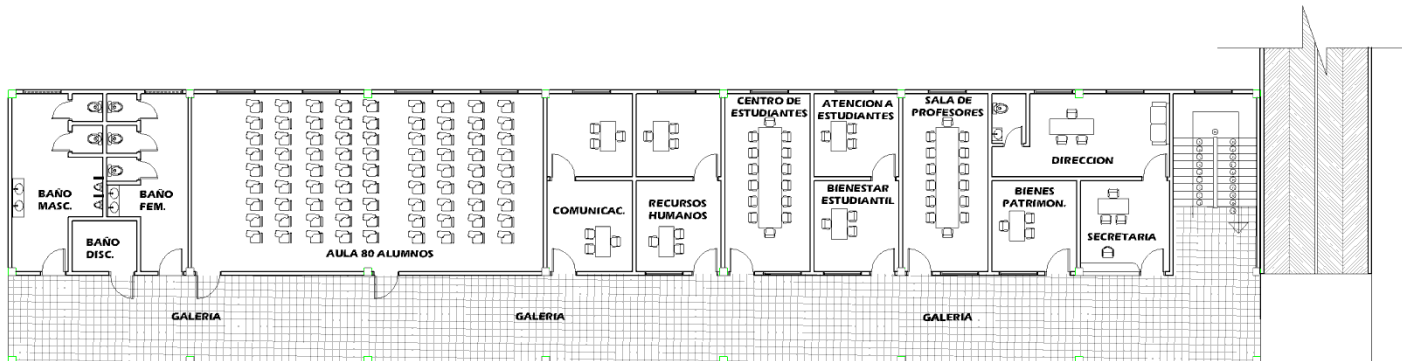

- AREA ADMINISTRATIVA/ACADEMICA

PLANTA 2DO PISO

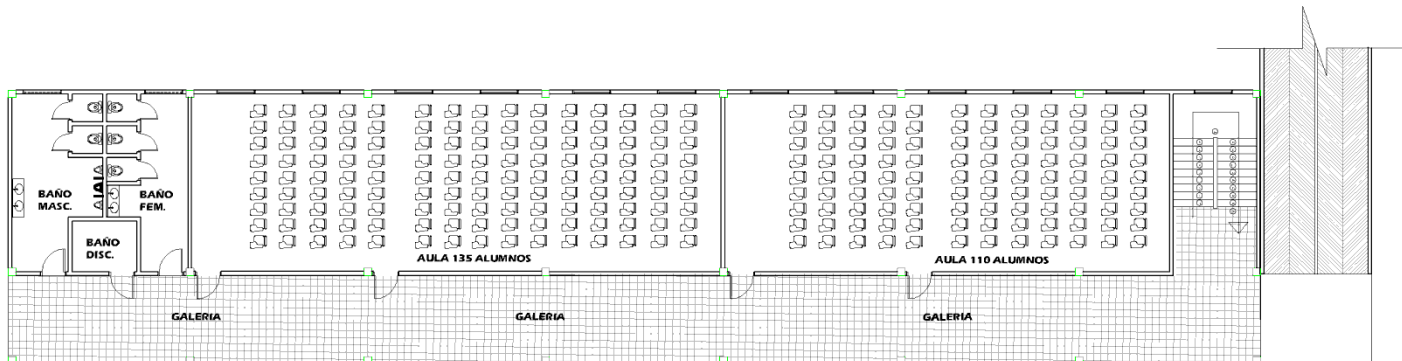

AULAS PREGRADO

Bloque 4

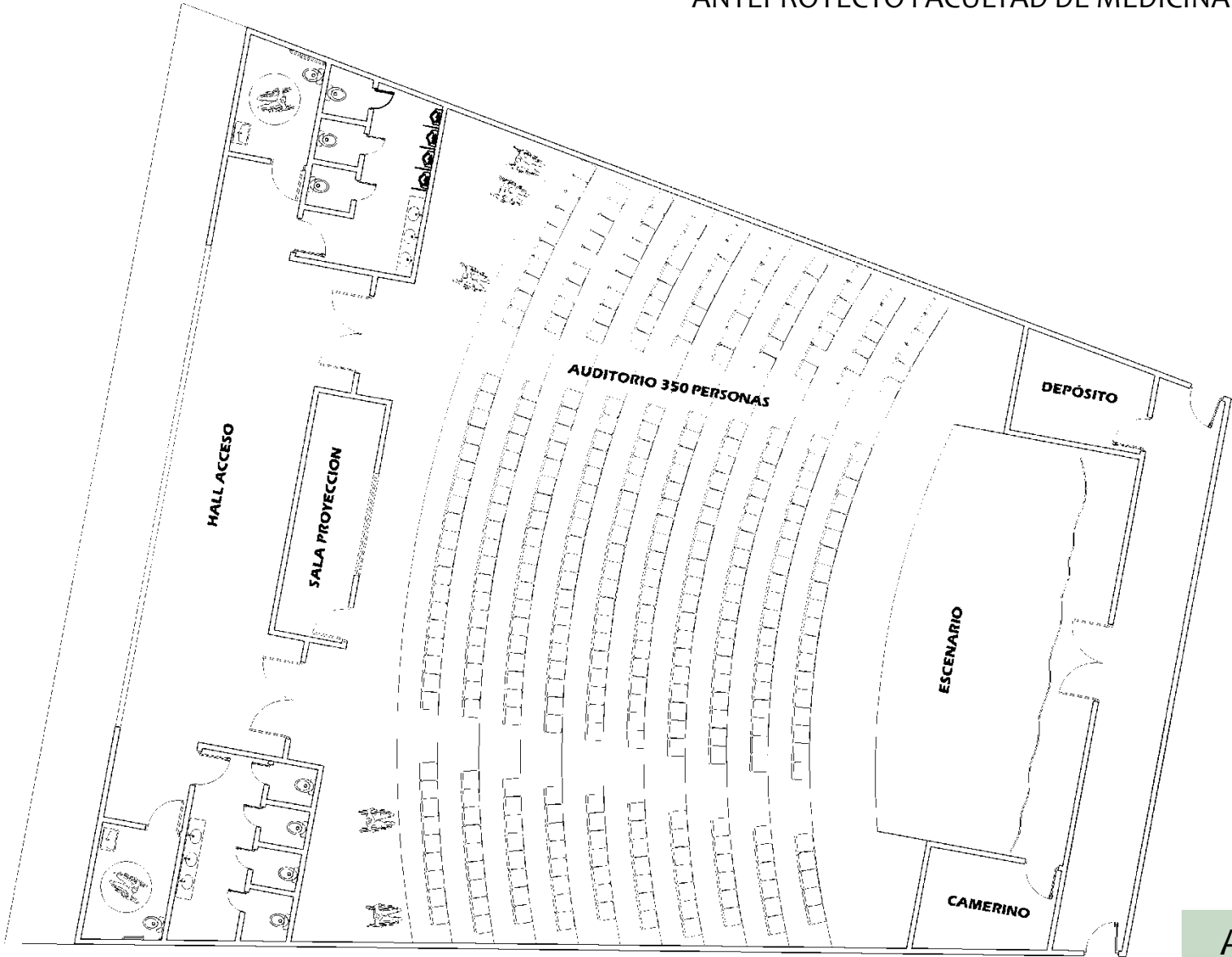

Auditorio

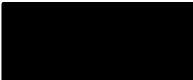

ANTEPROYECTO FACULTAD DE MEDICINA

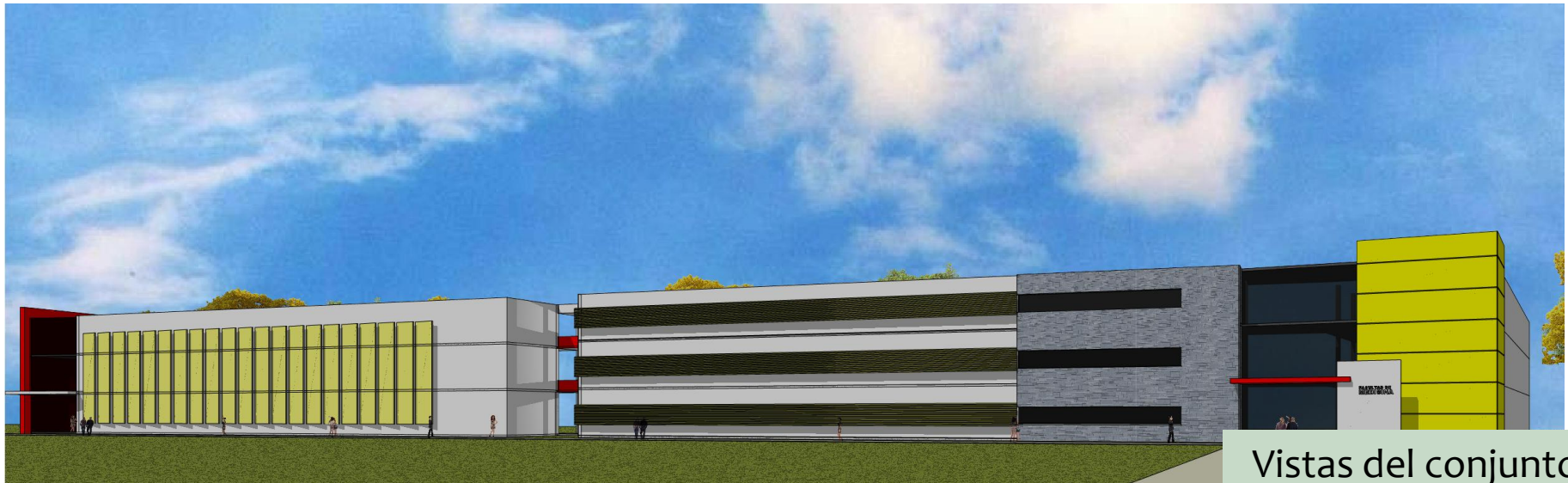

Vistas del conjunto

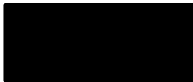

ANTEPROYECTO FACULTAD DE MEDICINA

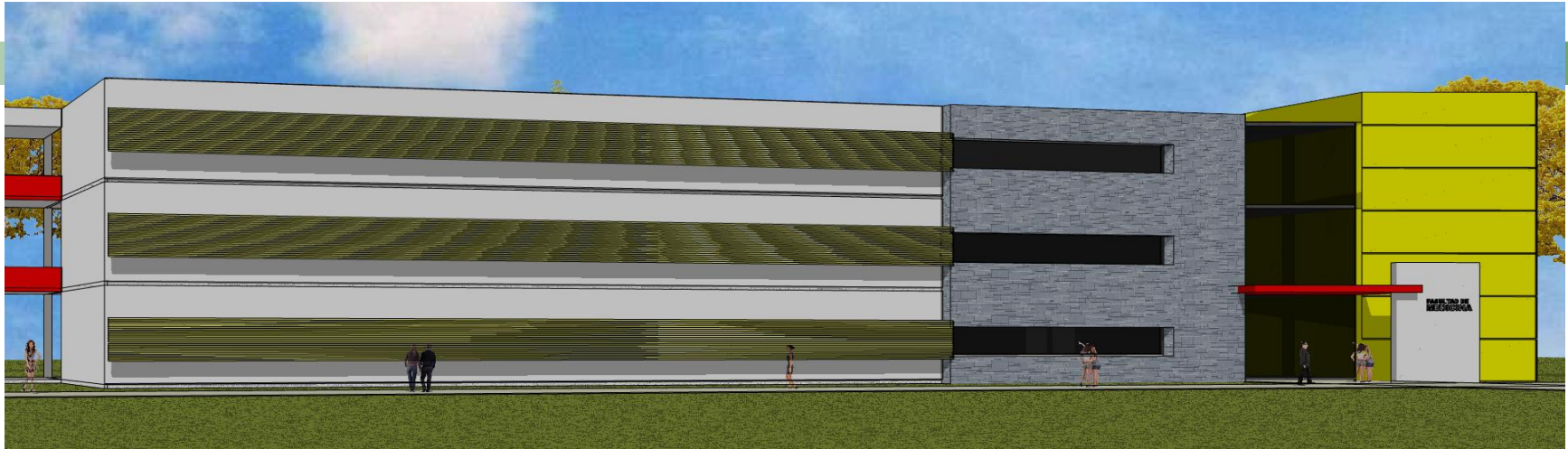

Vistas

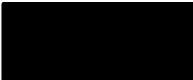

ANTEPROYECTO FACULTAD DE MEDICINA



Detalle de acceso



Detalles de parasoles

